

UL 50 - 2
2V 50AH
STANDBY

Ultracell®
 'Quality in Every Language'

Image

Terminal Type

**AWAITING
 IMAGE**

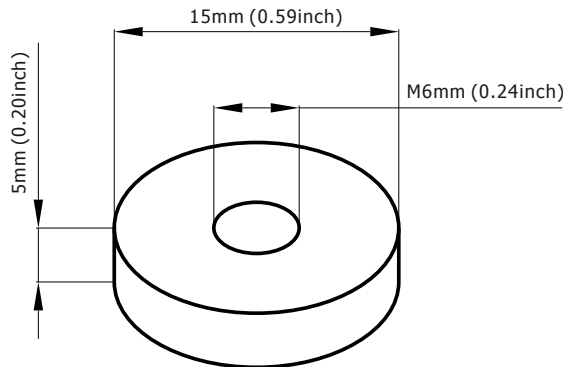

Dimensions

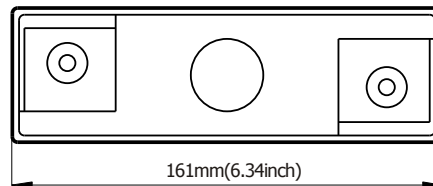
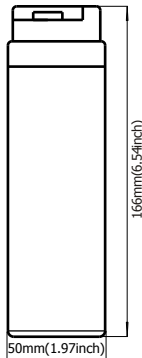
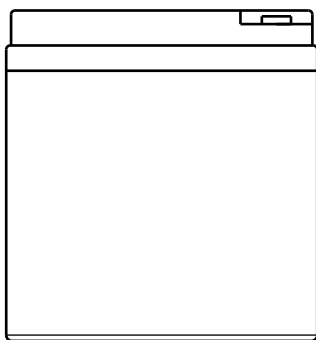

Specifications

Battery Model	UL 50 - 2			
Designed Floating Life	8 Years			
Capacity (25°C)	20HR (2.52A, 1.75V)	10HR (5A, 1.75V)	5HR (8.5A, 1.75V)	1HR (30A, 1.75V)
	50.4AH	50AH	42.5AH	30AH
Dimensions	Length	Width	Height	Total Height
	161mm(6.34inch)	50mm(1.97inch)	166mm(6.54inch)	166mm(6.54inch)
Approx. Weight	3.Kg (6.62 lbs)			
Internal Resistance	Fully Charged at 25°C 0.0012 Ohm			
Self Discharge	3% of capacity declined per month at 25°C			
Capacity Affected by Temperature	40°C	25°C	0°C	-15°C
	102%	100%	85%	65%
Charge Voltage (25°C)	Cycle Use		Float Use	
	2.4-2.46V (-5mV/C), max. Current: 12.5A		2.26-2.30V (-3.3mV/C)	

Construction

Component ——— Raw material
 Positive ——— Lead dioxide
 Negative ——— Lead
 Container ——— ABS (Flame Retardent optional)
 Cover ——— ABS (Flame Retardent optional)

Sealed and maintenance free option

Sealant ——— Epoxy Resin
 Safety Valve ——— EPDR
 Terminal ——— Copper
 Separator ——— Fibre Glass
 Electrolyte ——— Sulphuric acid

Non-spillable construction design



Tel | +44 (0) 151 523 2777
Fax | +44 (0) 151 523 0855
E-mail | info@ultracell.co.uk
Web | www.ultracell.co.uk

Charge Characteristic

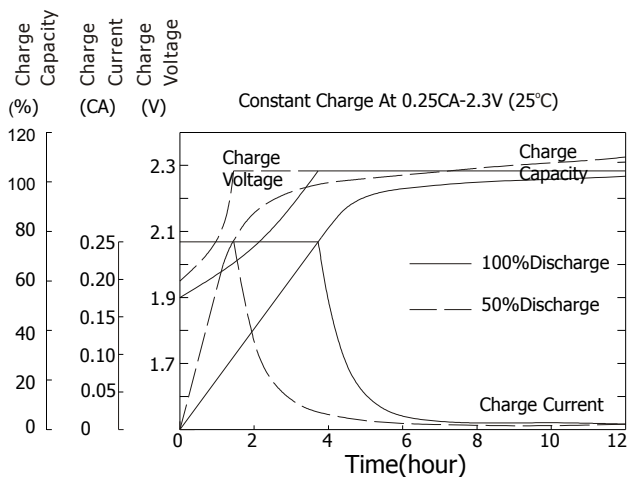

Discharge Characteristic 25°C

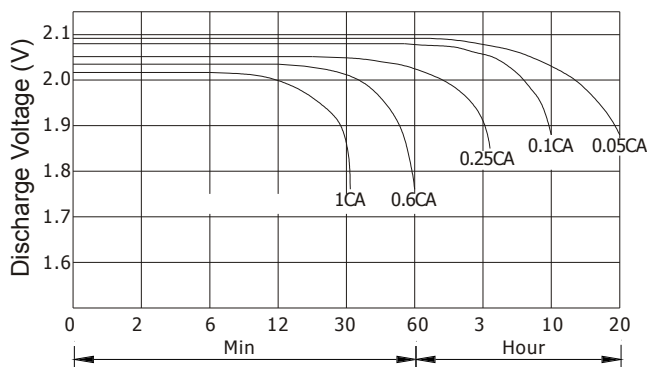

Relationship of OCV and state of charge

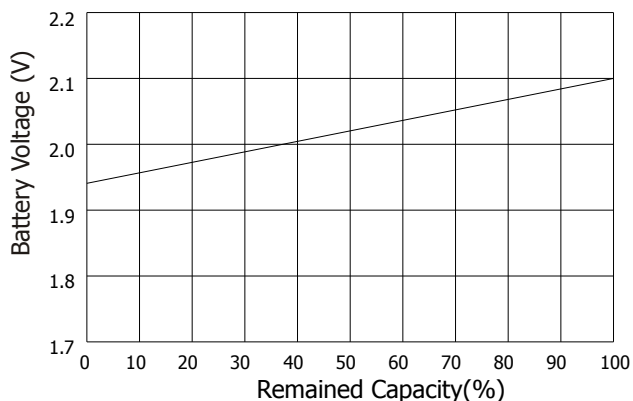

Self Discharge Characteristics

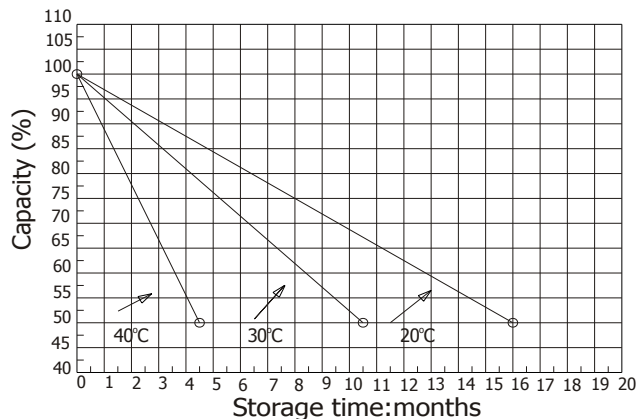

Constant Current Discharge Ratings - amperes at 25°C

F.V / Time	5 MIN	10 MIN	15 MIN	30 MIN	1 HR	3 HR	5 HR	10 HR	20 HR
1.60 V	175	120	87.5	52.5	33.0	13.7	9.54	5.30	2.64
1.67 V	158	110	85.0	51.0	33.0	13.6	9.46	5.22	2.63
1.70 V	150	106	82.0	50.0	32.9	13.6	9.46	5.18	2.63
1.75 V	133	97.5	77.5	49.0	32.5	13.5	9.38	5.09	2.61
1.80 V	120	90.5	74.0	47.5	32.1	13.5	9.31	5.00	2.52
1.85 V	91.0	74.5	64.0	43.7	31.8	13.4	9.23	4.92	2.37

Constant Power Discharge Ratings - watts at 25°C

F.V / Time	5 MIN	10 MIN	15 MIN	30 MIN	1 HR	3 HR	5 HR	10 HR	20 HR
1.60 V	289	199	155	99.0	65.0	26.2	18.3	10.6	5.27
1.67 V	274	197	154	97.0	62.9	26.2	18.3	10.4	5.25
1.70 V	256	192	151	94.5	31.2	26.2	18.3	10.4	5.25
1.75 V	238	179	142	92.0	60.7	25.8	18.1	10.2	5.23
1.80 V	214	167	134	89.5	59.6	25.5	17.8	10.0	5.04
1.85 V	171	138	117	82.0	59.1	25.4	17.5	9.8	4.74



Tel | +44 (0) 151 523 2777
Fax | +44 (0) 151 523 0855
E-mail | info@ultracell.co.uk
Web | www.ultracell.co.uk