

# UzS 250-2

2V 250AH

OPzS - UzS

# Ultracell®

'Quality in Every Language'

Image

AWAITING  
IMAGE

Terminal Type

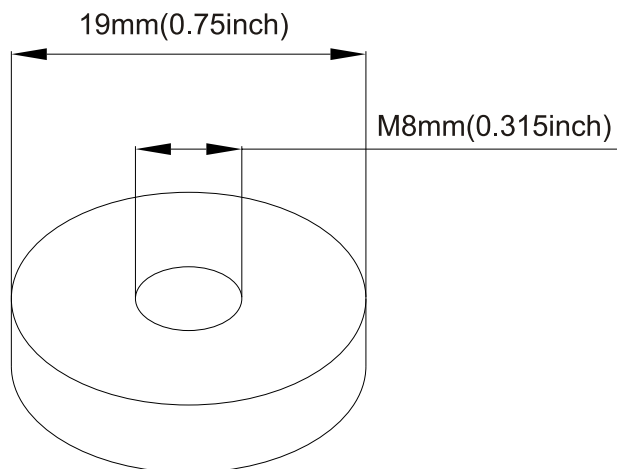

Dimensions

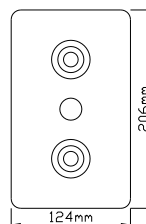
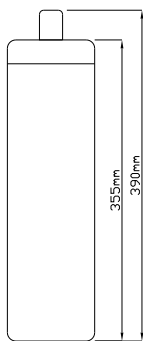

Specifications

Battery Model	UzS 250-2			
Capacity (25°C)	10HR (1.80V)	5HR (1.77V)	3HR (1.75V)	1HR (1.67V)
	250AH	215AH	187.5AH	132.5AH
Dimensions	Length	Width	Height	Total Height
	206mm	124mm	355mm	390mm
Approx. Weight	Approx. (with electrolyte) 21.3Kg ~ Approx. (without electrolyte) 16.3Kg			
Self Discharge	3% of capacity declined per month at 20°C			
Capacity Affected by Temperature	40°C	25°C	0°C	-15°C
	102%	100%	85%	65%

Construction

Component ——— Raw material  
 Positive ——— Lead dioxide  
 Negative ——— Lead  
 Container ——— ABS (Flame Retardent optional)  
 Cover ——— ABS (Flame Retardent optional)

*Sealed and maintenance free option*

Sealant ——— Epoxy Resin  
 Safety Valve ——— Rubber  
 Terminal ——— Copper  
 Separator ——— AGM or PVC-SiO<sub>2</sub>  
 Electrolyte ——— Sulphuric acid and SiO<sub>2</sub> colloid

*Non-spillable construction design*



CE 1188



MH 29410

**Tel** | +44 (0) 151 523 2777  
**Fax** | +44 (0) 151 523 0855  
**E-mail** | info@ultracell.co.uk  
**Web** | www.ultracell.co.uk

# UzS 250 - 2

2V 250AH

OPzS - UzS

# Ultracell®

'Quality in Every Language'

Cycle Service Life in Relation to Depth of Discharge

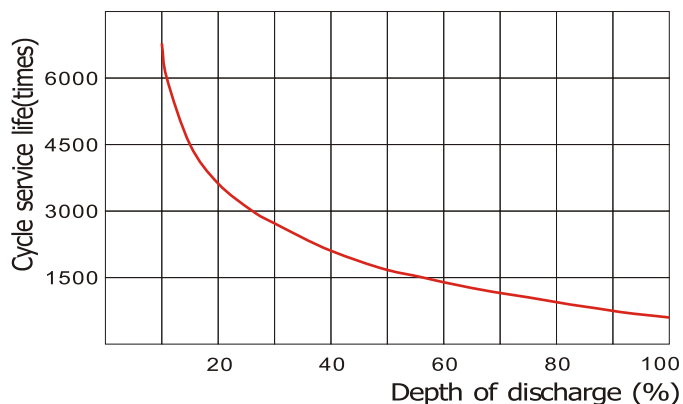

Discharge Characteristic Vs Ambient Temperature Curve

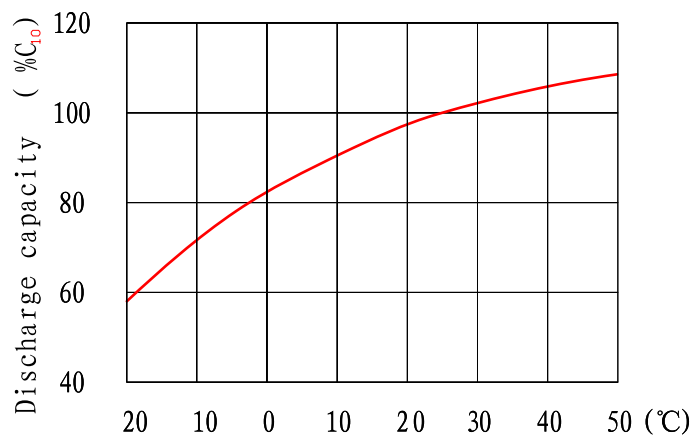

Relation Curves of Service Life and Ambient Temperature

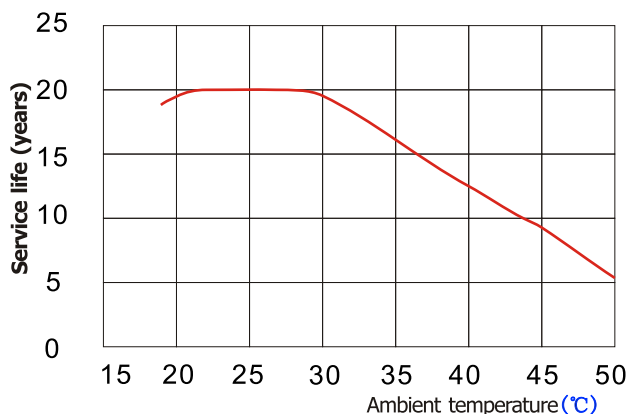

Charge Voltage Vs Ambient Temperature Curve

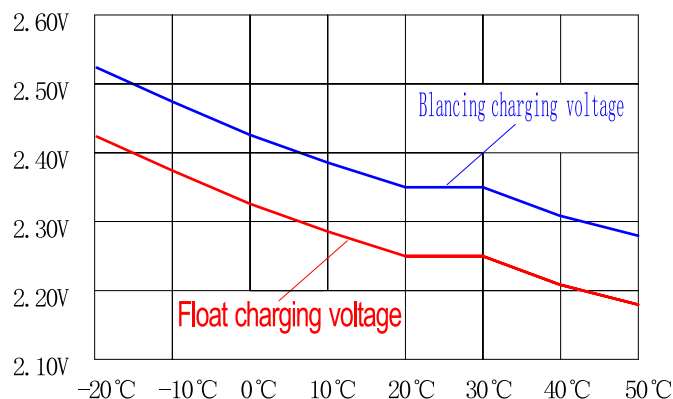

Discharge Characteristics 77°F (25°C)

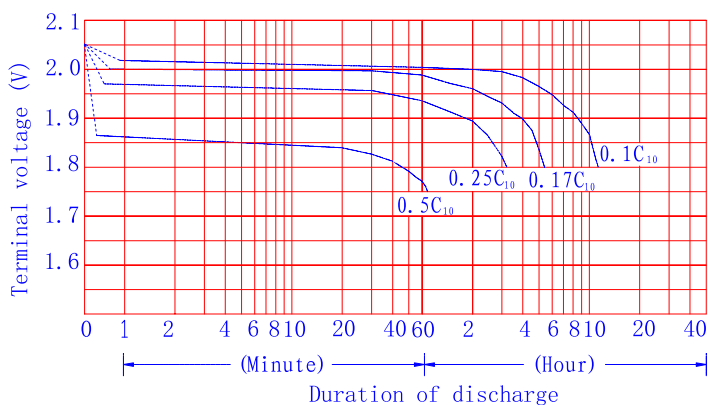

This information is generally descriptive only and is not intended to make or imply any representation, guarantee or warranty with respect to any cells and batteries. Cell and battery designs/specifications are subject to modification without notice.



CE 1188



MH 29410

Tel +44 (0) 151 523 2777  
 Fax +44 (0) 151 523 0855  
 E-mail info@ultracell.co.uk  
 Web www.ultracell.co.uk