

UzV 2000-2

2V 2000AH

OPzV - UzV

Ultracell®

'Quality in Every Language'

Image



Terminal Type

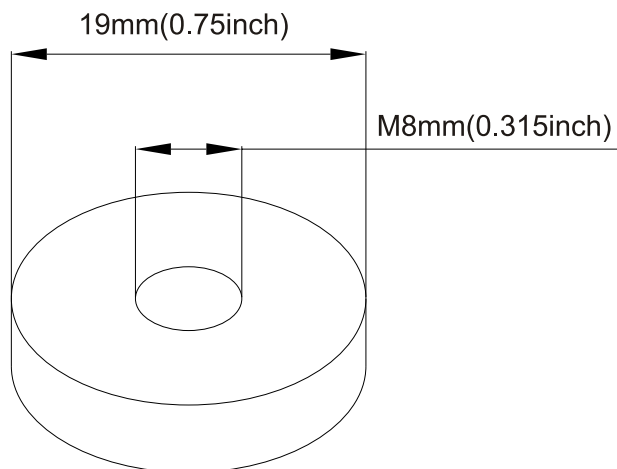

Dimensions

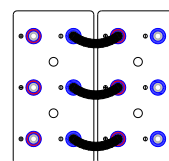
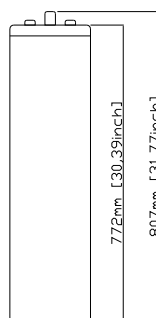
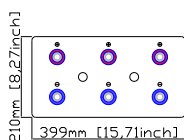
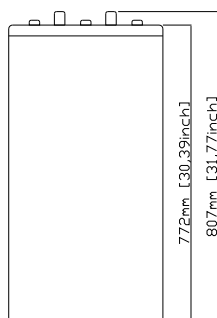

Specifications

Battery Model	UzV 2000-2			
Designed Floating Life	> 1200 cycles @ 80% DOD			
Capacity (25°C)	10HR (200A, 1.80V)	5HR (336A, 1.77V)	3HR (496A, 1.75V)	1HR (992A, 1.67V)
	2000AH	1680AH	1488AH	992AH
Dimensions	Length	Width	Height	Total Height
	399mm	210mm	772mm	807mm
Approx. Weight	156Kg +/- 5%			
Internal Resistance	Fully Charged at 20°C 0.004 Ohm			
Self Discharge	3% of capacity declined per month at 20°C			
Capacity Affected by Temperature	40°C	25°C	0°C	-15°C
	102%	100%	85%	65%
Charge Voltage (25°C)	Cycle Use		Float Use	
	2.35V (-4mV/°C), max. Current: 500A		2.25V (-3mV/°C)	

Construction

Component — Raw material
 Positive — Lead dioxide
 Negative — Lead
 Container — ABS (Flame Retardent optional)
 Cover — ABS (Flame Retardent optional)

Sealed and maintenance free option

Sealant — Epoxy Resin
 Safety Valve — Rubber
 Terminal — Copper
 Separator — AGM or PVC-SiO₂
 Electrolyte — Sulphuric acid and SiO₂ colloid

Non-spillable construction design



CE 1188



MH 29410

Tel | +44 (0) 151 523 2777
 Fax | +44 (0) 151 523 0855
 E-mail | info@ultracell.co.uk
 Web | www.ultracell.co.uk

UzV 2000 - 2

2V 2000AH

OPzV - UzV

Ultracell®

'Quality in Every Language'

Charge Characteristic

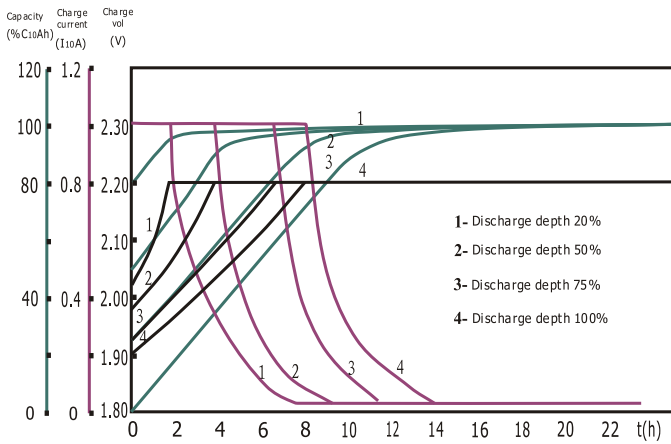

Discharge Characteristic 25°C

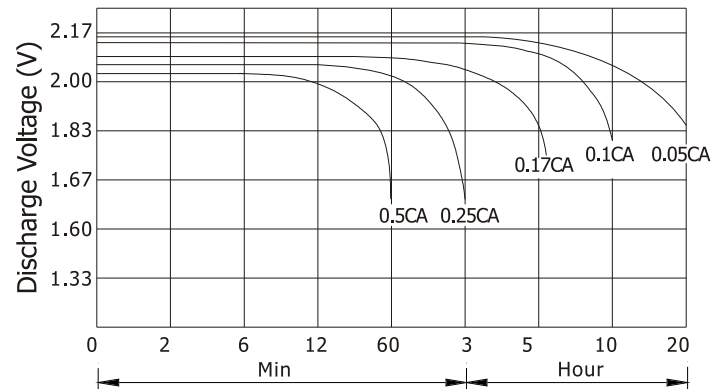

Available Capacity Vs. Ambient Temperature

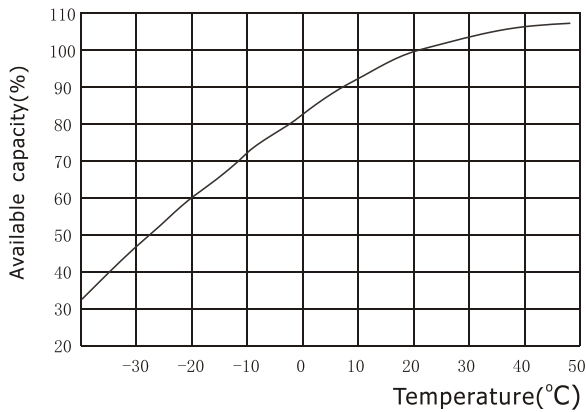

Float Voltage / Equivalent Voltage Vs. Temperature

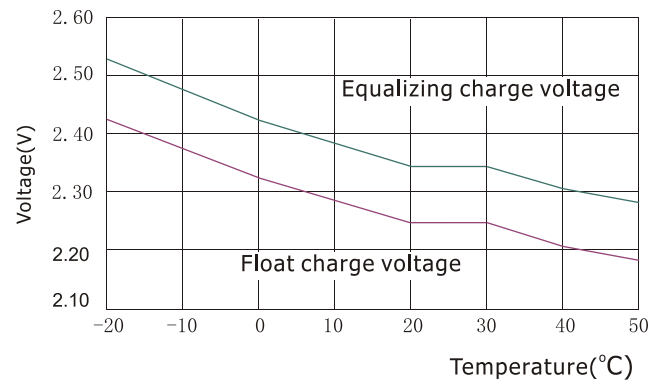

Constant Current Discharge Ratings - amperes at 20°C

F.V / Time	5 MIN	15 MIN	30 MIN	1 HR	2 HR	3 HR	4 HR	5 HR	10 HR
1.60 V	3500.0	2680.0	1880.0	1049.6	813.9	541.5	472.8	349.5	213.3
1.65 V	3366.8	2302.0	1668.5	1000.0	795.6	531.5	462.9	348.4	213.3
1.70 V	3116.4	2119.9	1542.9	740.4	785.2	528.6	462.1	346.2	212.0
1.75 V	2916.3	1847.8	1373.1	716.0	700.0	496.0	429.0	340.0	205.7
1.80 V	2560.9	1666.4	1181.6	604.5	659.0	459.8	400.0	332.0	200.0
1.85 V	2168.7	1391.5	921.9	469.2	604.8	406.6	360.2	311.9	191.9

Constant Power Discharge Ratings - watts at 20°C

F.V / Time	5 MIN	15 MIN	30 MIN	1 HR	2 HR	3 HR	4 HR	5 HR	10 HR
1.60 V	5950.0	4582.8	3233.6	1899.8	1481.3	990.9	870.0	654.3	418.0
1.65 V	5824.6	4005.4	2919.8	1830.0	1464.0	988.6	868.7	651.6	417.7
1.70 V	5484.9	3752.2	2746.3	1369.8	1460.5	983.2	861.0	649.4	415.9
1.75 V	5220.2	3326.0	2485.3	1338.9	1316.0	937.4	815.0	646.6	407.3
1.80 V	4660.9	3049.6	2174.2	1142.5	1252.1	878.2	768.0	640.8	398.0
1.85 V	4077.2	2629.9	1751.7	905.5	1173.3	793.0	706.0	614.3	385.6



Tel +44 (0) 151 523 2777
 Fax +44 (0) 151 523 0855
 E-mail info@ultracell.co.uk
 Web www.ultracell.co.uk